



All dimensions to be confirmed on site prior to construction

REV.	DATE	DESCRIPTION
A	10.04.26	For comment

www.buildingconsents.nz

154-178 Barwon Heads Rd,
Belmont, Victoria, 3216



This copied document is made available for the sole purpose of enabling its consideration and review as part of a planning process under the Planning and Environment Act 1987. The document must not be used for any purpose which may breach copyright legislation

Location Plan

DRAWING NO.	REVISION
A01	A

SCALE at A3
1 : 1000

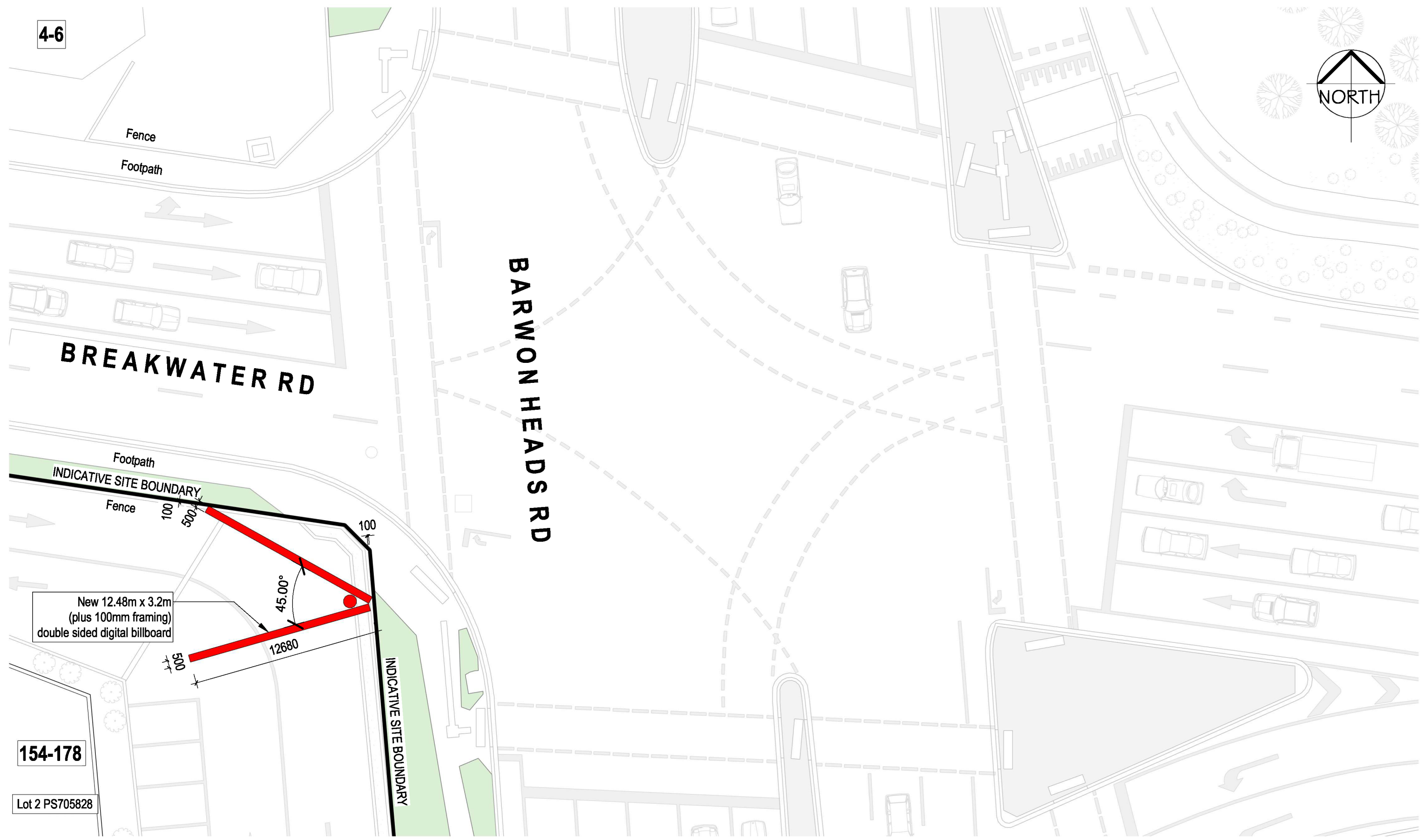

4-6



BREAKWATER RD

BARWON HEADS RD

New 12.48m x 3.2m
(plus 100mm framing)
double sided digital billboard

12680

45.00°

500

100

INDICATIVE SITE BOUNDARY

154-178

Lot 2 PS705828

All dimensions to be confirmed on site prior to construction

REV.	DATE	DESCRIPTION
A	10.04.26	For comment

www.buildingconsents.nz

154-178 Barwon Heads Rd,
Belmont, Victoria, 3216



Site Plan

DRAWING NO. **A02** REVISION **A**

SCALE at A3
1 : 250

This copied document is made available for the sole purpose of enabling its consideration and review as part of a planning process under the Planning and Environment Act 1987. The document must not be used for any purpose which may breach copyright legislation



CODE	DESCRIPTION	SPECIFICATION	COLOUR	IMAGE
CT1	CLADDING TYPE ONE	SOLID ALLUMINUM CLADDING SPECIFICATION Thickness to fabricator's specification Finish: proprietary powdercoat system for marine environments	Colour to match Colorbond 'Monument'	
CT2	CLADDING TYPE TWO	PYLON CLADDING SPECIFICATION Vitrapanel Thickness: 9mm Finish: Pre-finished Coating: Single-sided	Colour to match Colorbond 'Monument'	
PM1	PERFORATED METAL TYPE	PERFORATED METAL SPECIFICATION Locker Group Perforated Aluminum screening Code: R09540A530 Open Area: 40% Thickness: To fabricator's specifications Finish: Powdercoat (marine grade finish to coastal environments) Proprietary rubber separation system at all fixing points. All screen to be custom made. Allow for 50mm margin at perimeter.	Colour to match Colorbond 'Monument'	 Round Hole Straight 10mm
DD1	DIGITAL DISPLAY TYPE	DIGITAL DISPLAY SCREEN SPECIFICATION Refer to fabricator's specification		

Table 1: Billboard materials and finishes

1 Perspective
NTS

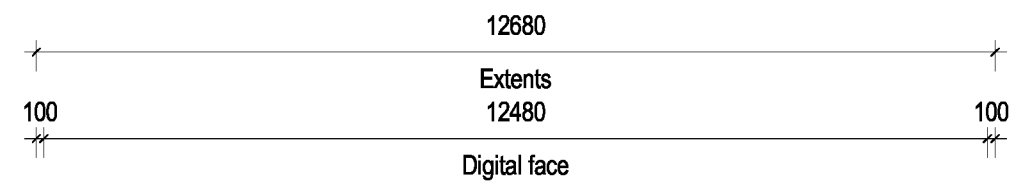

1 North East Elevation
1 : 100

All dimensions to be confirmed on site prior to construction

REV.	DATE	DESCRIPTION
A	10.04.26	For comment

www.buildingconsents.nz

154-178 Barwon Heads Rd,
Belmont, Victoria, 3216



Elevation and
Perspective

DRAWING NO.	REVISION
A03	A
SCALE at A3 1 : 100	

This copied document is made available for the sole purpose of enabling its consideration and review as part of a planning process under the Planning and Environment Act 1987. The document must not be used for any purpose which may breach copyright legislation



All dimensions to be confirmed on site prior to construction

REV.	DATE	DESCRIPTION
A	10.04.26	For comment



Building Consents



www.buildingconsents.nz

**154-178 Barwon Heads Rd,
Belmont, Victoria, 3216**

This copied document is made available for the sole purpose of enabling its consideration and review as part of a planning process under the Planning and Environment Act 1987. The document must not be used for any purpose which may breach copyright legislation



View 1 - Indicative only

DRAWING NO.	REVISION
A04	A
SCALE at A3	



All dimensions to be confirmed on site prior to construction

REV.	DATE	DESCRIPTION
A	10.04.26	For comment



Building Consents



www.buildingconsents.nz

**154-178 Barwon Heads Rd,
Belmont, Victoria, 3216**

This copied document is made available for the sole purpose of enabling its consideration and review as part of a planning process under the Planning and Environment Act 1987. The document must not be used for any purpose which may breach copyright legislation



View 2 - Indicative only

DRAWING NO.	REVISION
A05	A

SCALE at A3