

- denotes roof area connected to 2000 litre water tanks
- denotes concrete driveway (treated)
- denotes concrete paving (treated)
- denotes raingarden

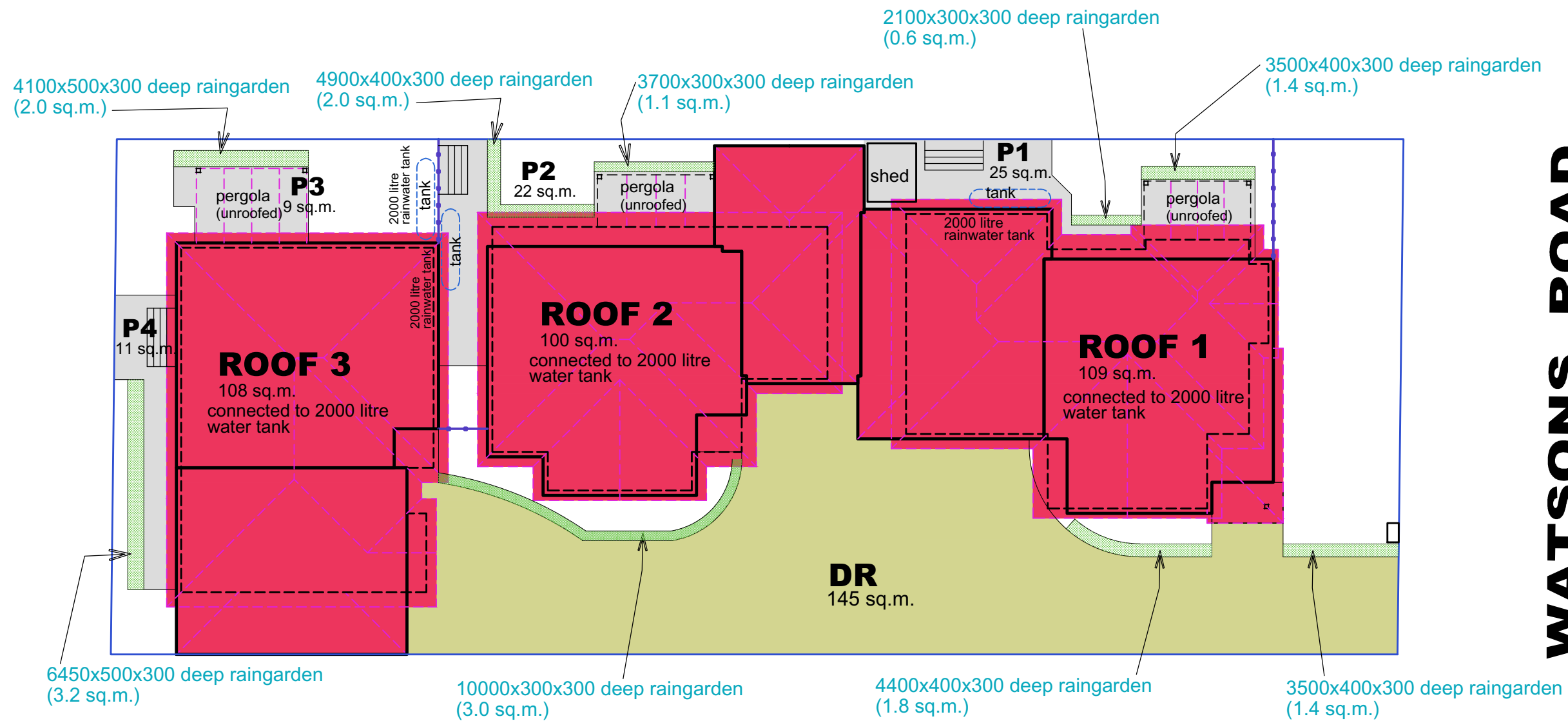

WATSONS ROAD

STORM report

scale 1:150

proposed 3-unit development

at: No.39 Watsons Road, Newcomb
for: Remo Property Geelong



9 Keith Place, Hamlyn Heights
email: michael@mtvdesign.com.au 0414 410 410
website: mtvdesign.com.au

drawn: mtv	issue: B
date: March 2026	reg. no. DP-AD1767
file: 25PR807	scale: 1:150 / A3
sheet no. 1 of 3	job no. 223715

This copied document is made available for the sole purpose of enabling its consideration and review as part of a planning process under the Planning and Environment Act 1987. The document must not be used for any purpose which may breach copyright legislation

mtvdesign.com.au

39 watsons road, newcomb
The proposed stormwater treatments comply with all the relevant objectives for management of stormwater flows on-site.

182%
SCORE

Project details

Name: 39 watsons road, newcomb
Street address: 39 Watsons Rd, Newcomb VIC 3219, Australia
Municipality: Greater Geelong
Site area: 628 m²
Planning Number:

Flow and pollutant load reductions

Item	Result	Target
Mean annual runoff volume harvested or evapotranspired (%)	55%	>28%
Mean annual runoff volume infiltrated or filtered (%)	9%	>9%
Total suspended solids (%)	90%	>80%
Total phosphorus (%)	79%	>45%
Total nitrogen (%)	82%	>45%
Total gross pollutants (%)	99%	>70%

Water treatment

Catchments

- roof 1 Roof, 109m²
- roof 2 Roof, 100m²
- roof 3 Roof, 108m²
- driveway Paved, 145m²
- paving 1 Paved, 25m²
- paving 2 Paved, 22m²
- paving 3 Paved, 13m²
- paving 4 Paved, 11m²

Warning: Total catchment area of 533m² is 95m² below total area of 628m²

STORM report

proposed 3-unit development

address No.39 Watsons Road, Newcomb

client Remo Property Geelong

Treatments

Rainwater Tank 1 Rainwater tank retention volume in kilolitres: 2	177%
Rainwater Tank 2 Rainwater tank retention volume in kilolitres: 2	168%
Rainwater Tank 3 Rainwater tank retention volume in kilolitres: 2	178%
Raingarden 1 Area: 6 m ² , Extended detention depth: 0.3 m, Submerged zone depth: 0.3 m, Site soil type: Clay	190%
Raingarden 2 Area: 2 m ² , Extended detention depth: 0.3 m, Submerged zone depth: 0.3 m, Site soil type: Clay	200%
Raingarden 3 Area: 3 m ² , Extended detention depth: 0.3 m, Submerged zone depth: 0.3 m, Site soil type: Clay	204%
Raingarden 4 Area: 2 m ² , Extended detention depth: 0.3 m, Submerged zone depth: 0.3 m, Site soil type: Clay	204%
Raingarden 5 Area: 3 m ² , Extended detention depth: 0.3 m, Submerged zone depth: 0.3 m, Site soil type: Clay	204%

Buildings & dwellings

- Building 1 Residential Townhouse, 3 bedroom(s)
- Building 2 Residential Townhouse, 2 bedroom(s)
- Building 3 Residential Townhouse, 3 bedroom(s)

drawn: mtv	issue: B
date: March 2026	reg. no. DP-AD1767
file: 25PR807	scale:
sheet no. 2 of 3	job no. 223715



9 Keith Place, Hamlyn Heights
email: michael@mtvdesign.com.au 0414 410 410
website: mtvdesign.com.au

Configuration 1	
roof 1 Roof, 109m ²	
Rainwater Tank 1 Rainwater tank retention volume in kilolitres: 2,	177%
Building 1 Residential Townhouse, 3 bedroom(s)	
Configuration 2	
roof 2 Roof, 100m ²	
Rainwater Tank 2 Rainwater tank retention volume in kilolitres: 2,	168%
Building 2 Residential Townhouse, 2 bedroom(s)	
Configuration 3	
roof 3 Roof, 108m ²	
Rainwater Tank 3 Rainwater tank retention volume in kilolitres: 2,	178%
Building 3 Residential Townhouse, 3 bedroom(s)	
Configuration 4	
driveway Paved, 145m ²	
Raingarden 1 Area: 6 m ² , Extended detention depth: 0.3 m, Submerged zone depth: 0.3 m, Site soil type: Clay,	190%
Configuration 5	
paving 1 Paved, 25m ²	
Raingarden 2 Area: 2 m ² , Extended detention depth: 0.3 m, Submerged zone depth: 0.3 m, Site soil type: Clay,	200%
Configuration 6	
paving 2 Paved, 22m ²	
Raingarden 3 Area: 3 m ² , Extended detention depth: 0.3 m, Submerged zone depth: 0.3 m, Site soil type: Clay,	204%
Configuration 7	
paving 3 Paved, 13m ²	
Raingarden 4 Area: 2 m ² , Extended detention depth: 0.3 m, Submerged zone depth: 0.3 m, Site soil type: Clay,	204%
Configuration 8	
paving 4 Paved, 11m ²	
Raingarden 5 Area: 3 m ² , Extended detention depth: 0.3 m, Submerged zone depth: 0.3 m, Site soil type: Clay,	204%

STORM report

proposed 3-unit development

at: No.39 Watsons Road, Newcomb
 for: Remo Property Geelong



9 Keith Place, Hamlyn Heights
 email: michael@mtvdesign.com.au 0414 410 410
 website: mtvdesign.com.au

This copied document is made available for the sole purpose of enabling its consideration and review as part of a planning process under the Planning and Environment Act 1987. The document must not be used for any purpose which may breach copyright legislation

drawn: mtv	issue: B
date: March 2026	reg. no. DP-AD1767
file: 25PR807	scale:
sheet no. 3 of 3	job no. 223715