

WATSONS ROAD

unit 3 swept path diagrams
scale 1:100

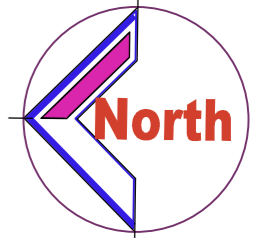

proposed 3-unit development	
address	No. 39 Watsons Road, Newcomb
client	Remo Property Geelong

9 Keith Place, Hamlyn Heights
email: michael@mtvdesign.com.au 0414 410 410
website: mtvdesign.com.au

title:	town planning applications
drawing:	site / ground floor plan

--	--

drawn	mtv	date	March 2026
issue:	B	scale	1:100/A2
reg. no.	DP-AD1767	file:	25PR807
sheet no.	1 of 2	job no.	223715

WATSONS ROAD

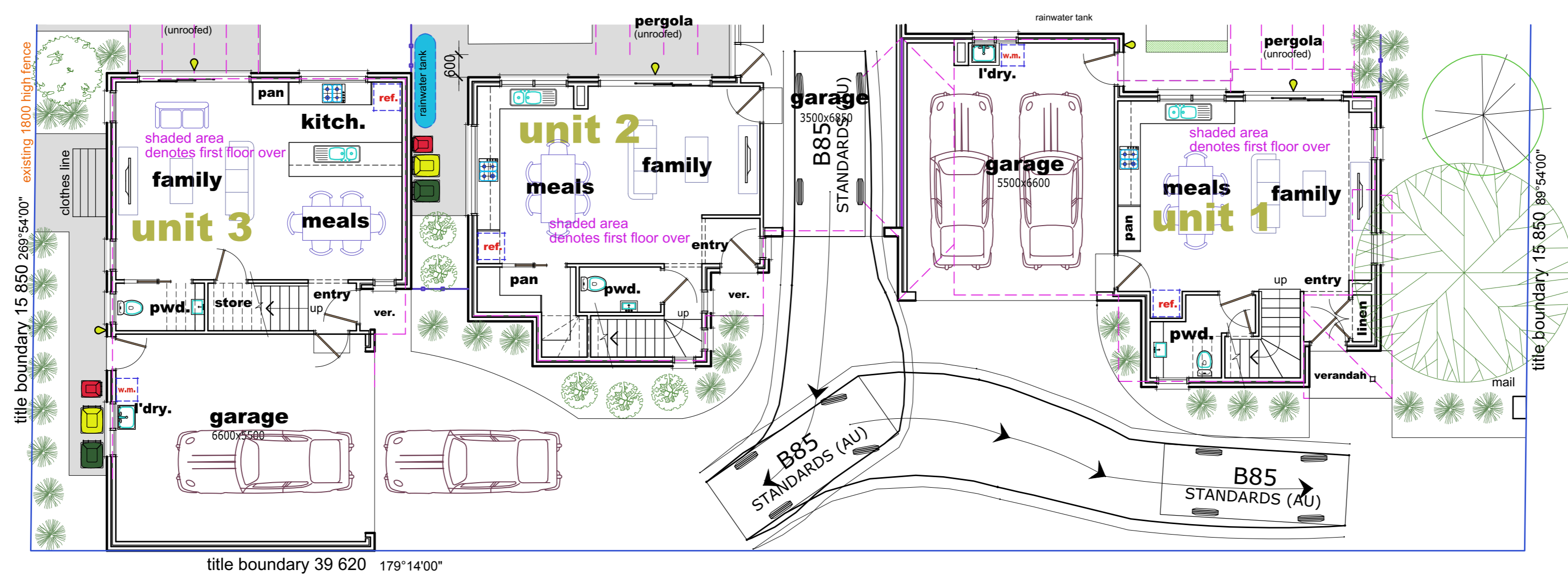

unit 2 swept path diagram
scale 1:100

proposed 3-unit development
address No. 39 Watsons Road, Newcomb
client Remo Property Geelong



title:
town planning applications
drawing:
site / ground floor plan

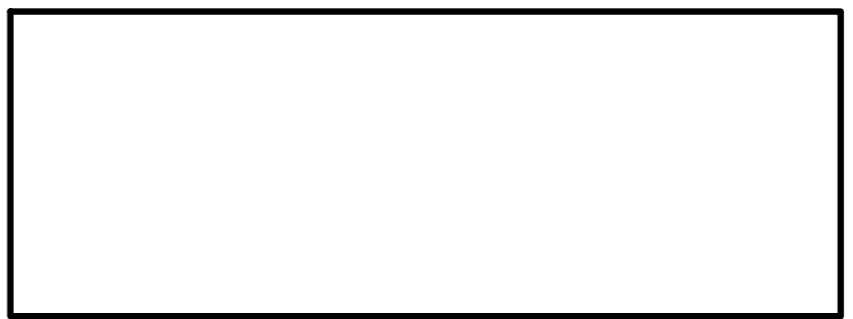

drawn	mtv	date	March 2026
issue:	B	scale	1:100/A2
reg. no.	DP-AD1767	file:	25PR807
sheet no.	2 of 2	job no.	223715