

# PowerPanel<sup>XL</sup>

For fast solid walls with a rendered finish and outstanding thermal and fire resistance.

Hebel PowerPanel<sup>XL</sup> has been developed and tested for low rise residential external and zero boundary wall systems, which are warranted by CSR Hebel.

**hebel**<sup>®</sup>  
The better way to build

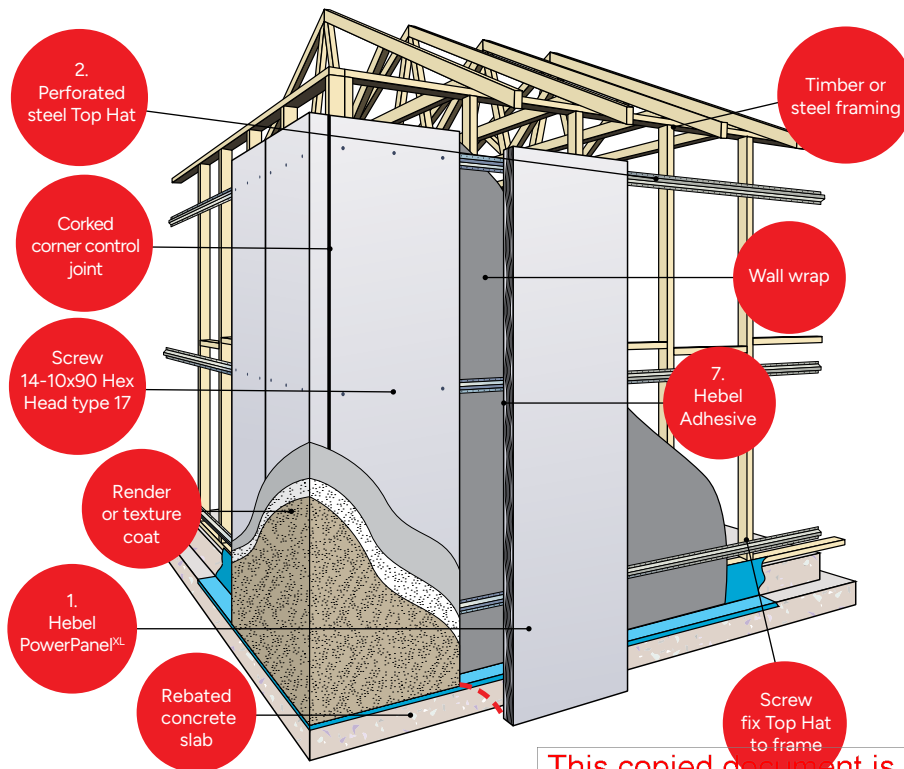

This copied document is made available for the sole purpose of enabling its consideration and review as part of a planning process under the Planning and Environment Act 1987.

The document must not be used for any purpose which may breach copyright legislation.

## PowerPanel<sup>XL</sup> External Wall System

The PowerPanel<sup>XL</sup> system consists of 75mm thick, steel-reinforced AAC panels, vertically secured to the structural frame via horizontal perforated top hat sections. The wall is then rendered with a recommended coating system – providing a faster way of constructing external facades for residential builds.

- Fire rating: Up to 180/180/180 when subjected to an external fire source (FRL of wall system without construction joints)
- Acoustic: Up to  $R_w + C_{tr}$  33
- Thermal:  $R_{0.6}$   $m^2.K/W$  for 4.0% M.C for panel only and up to  $R_{3.8}$   $m^2.K/W$  in wall system
- Common Wall Thickness: 199mm, based on 90mm stud + 10mm plasterboard + 24mm top hat + 75mm PowerPanel<sup>XL</sup>  
With variations in stud thickness and top hats, wall widths can vary between 173mm to 212mm.

**Note:** Refer to relevant Design and Installation Guide on website or contact Technical services team for further details on performance of variety of wall system configurations.

## PowerPanel<sup>XL</sup> Standard Panel Sizes

75mm thick x 600mm wide x 2400mm, 2550mm, 2700mm, 2800mm, 2850mm, 3000mm and 3300mm long.

## External Walls - Houses & Low Rise Multi Residential

- delivers quality solid walls finished with a flexible coating system
- excellent thermal performance – PowerPanel<sup>XL</sup> has almost 2 times more thermal resistance than a standard brick
- fast to construct - one standard Hebel panel is the equivalent of 75 traditional bricks, which means an average sized home can go up as quickly as within 3 days when installed by experienced Hebel installers
- good acoustic performance
- patterns can be machined or routed into the panels to produce an individual, attractive finish
- system meets or exceeds all six Bushfire Attack Level (BAL) categories

