

Doc id: 01692/261 Matter: 11573-03 Search generated on 20/05/2014 at 09:12

Copyright State of Victoria. This publication is copyright.
No part may be reproduced by any process except in accordance with the provisions of the Copyright Act and for the purposes of Section 32 of the Sale of Land Act 1962 or pursuant to a written agreement. The information is only valid at the time and in the form obtained from the LANDATA REGD TM System. The State of Victoria accepts no responsibility for any subsequent release, publication or reproduction of the information.

REGISTER SEARCH STATEMENT (Title Search) Transfer of Land Act 1958

VOLUME 01692 FOLIO 261

Security no : 124050587893N
Produced 20/05/2014 09:12 am

LAND DESCRIPTION

Lot 1 on Title Plan 606397D.
PARENT TITLE Volume 01654 Folio 730
Created by instrument 0147711 13/05/1885

REGISTERED PROPRIETOR

Estate Fee Simple
Sole Proprietor
L BISINELLA DEVELOPMENTS PTY LTD of 195 FOREST ROAD LARA VIC 3212
AH796370P 18/02/2011

ENCUMBRANCES, CAVEATS AND NOTICES

Any encumbrances created by Section 98 Transfer of Land Act 1958 or Section 24 Subdivision Act 1988 and any other encumbrances shown or entered on the plan set out under DIAGRAM LOCATION below.

DIAGRAM LOCATION

SEE TP606397D FOR FURTHER DETAILS AND BOUNDARIES

ACTIVITY IN THE LAST 125 DAYS

NIL

-----END OF REGISTER SEARCH STATEMENT-----

Additional information: (not part of the Register Search Statement)

Street Address: 130-150 FOREST ROAD SOUTH LARA VIC 3212

DOCUMENT END

Delivered from the LANDATA® System by GLOBALX INFORMATION PTY LTD

130-150 Forest Rd
Lara, 3212

TITLE PLAN	EDITION 1	TP 606397D
-------------------	------------------	-------------------

Location of Land

Parish: MDRANGHURK
 Township:
 Section: 15
 Crown Allotment:
 Crown Portion: C (PT)

Last Plan Reference

Derived From: VOL 1692 FOL 261
 Depth Limitation: NIL

Notations

ANY REFERENCE TO MAP IN THE TEXT MEANS THE DIAGRAM SHOWN ON THIS TITLE PLAN

Description of Land / Easement Information

THIS PLAN HAS BEEN PREPARED FOR THE LAND REGISTRY, LAND VICTORIA FOR TITLE DIAGRAM PURPOSES AS PART OF THE LAND TITLES AUTOMATION PROJECT

COMPILED: 18/00/2000
 VERIFIED: AK

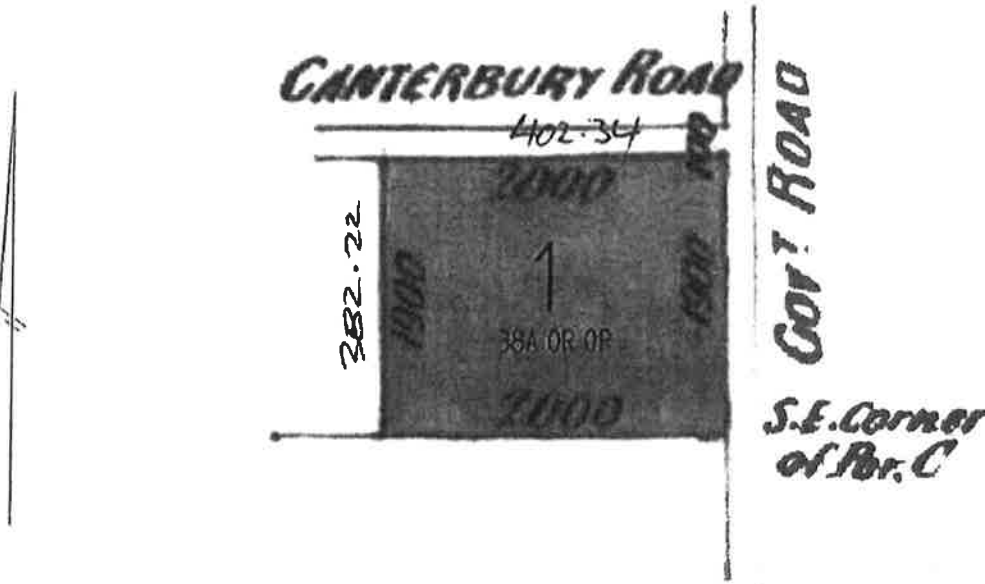

TABLE OF PARCEL IDENTIFIERS
WARNING: Where multiple parcels are referred to or shown on this Title Plan this does not imply separately disposable parcels under Section 8A of the Sale of Land Act 1962
PARCEL 1 - CPO (PT)

LENGTHS ARE IN LINKS	Metres = 0.3048 x Feet Metres = 0.201168 x Links	
		Sheet 1 of 1 sheets