

**REGISTER SEARCH STATEMENT (Title Search) Transfer of
Land Act 1958**

Page 1 of 1

VOLUME 01378 FOLIO 437
No CofT exists
CROWN GRANT

Security no : 124055546577P
Produced 09/06/2015 01:56 pm

LAND DESCRIPTION

Crown Allotment D Section 13 Township of Drysdale Parish of Bellarine.

REGISTERED PROPRIETOR

Estate Fee Simple
Sole Proprietor
STATE RIVERS AND WATER SUPPLY COMMISSION
G697670 07/07/1977

**CITY OF GREATER GEELONG
STATUTORY PLANNING**

**23 OCT 2015
RECEIVED**

ENCUMBRANCES, CAVEATS AND NOTICES

Any crown grant reservations exceptions conditions limitations and powers noted on the plan or imaged folio set out under DIAGRAM LOCATION below. For details of any other encumbrances see the plan or imaged folio set out under DIAGRAM LOCATION below.

DIAGRAM LOCATION

SEE TP870646F FOR FURTHER DETAILS AND BOUNDARIES

ACTIVITY IN THE LAST 125 DAYS

NIL

-----END OF REGISTER SEARCH STATEMENT-----

Additional information: (not part of the Register Search Statement)

Street Address: 40-42 NEWCOMBE STREET DRYSDALE VIC 3222

DOCUMENT END

Imaged Document Cover Sheet

The document following this cover sheet is an imaged document supplied by LANDATA®, Land Victoria.

Document Type	plan
Document Identification	TP870646F
Number of Pages (excluding this cover sheet)	2
Document Assembled	09/06/2015 13:56

Copyright and disclaimer notice:

© State of Victoria. This publication is copyright. No part may be reproduced by any process except in accordance with the provisions of the Copyright Act and for the purposes of Section 32 of the Sale of Land Act 1962 or pursuant to a written agreement. The information is only valid at the time and in the form obtained from the LANDATA® System. The State of Victoria accepts no responsibility for any subsequent release, publication or reproduction of the information.

The document is invalid if this cover sheet is removed or altered.

TITLE PLAN	EDITION 1	TP 870646F
LOCATION OF LAND Parish: BELLARINE Township: DRYSDALE Section: 13 Crown Allotment: D Crown Portion: Last Plan Reference: Derived From: VOL. 1378 FOL. 437 Depth Limitation: NIL	Notations SUBJECT TO THE RESERVATIONS, EXCEPTIONS, CONDITIONS AND POWERS CONTAINED IN CROWN GRANT VOL.1378 FOL.437 AND NOTED ON SHEET 2 OF THIS PLAN ANY REFERENCE TO MAP IN THE TEXT MEANS THE DIAGRAM SHOWN ON THIS TITLE PLAN	

Description of Land/Easement Information

THIS PLAN HAS BEEN PREPARED BY LAND REGISTRY, LAND VICTORIA FOR TITLE DIAGRAM PURPOSES
 COMPILED: Date: 09/01/2007
 VERIFIED: A. DALLAS
Assistant Registrar of Titles

COLOUR CODE
 Y= YELLOW

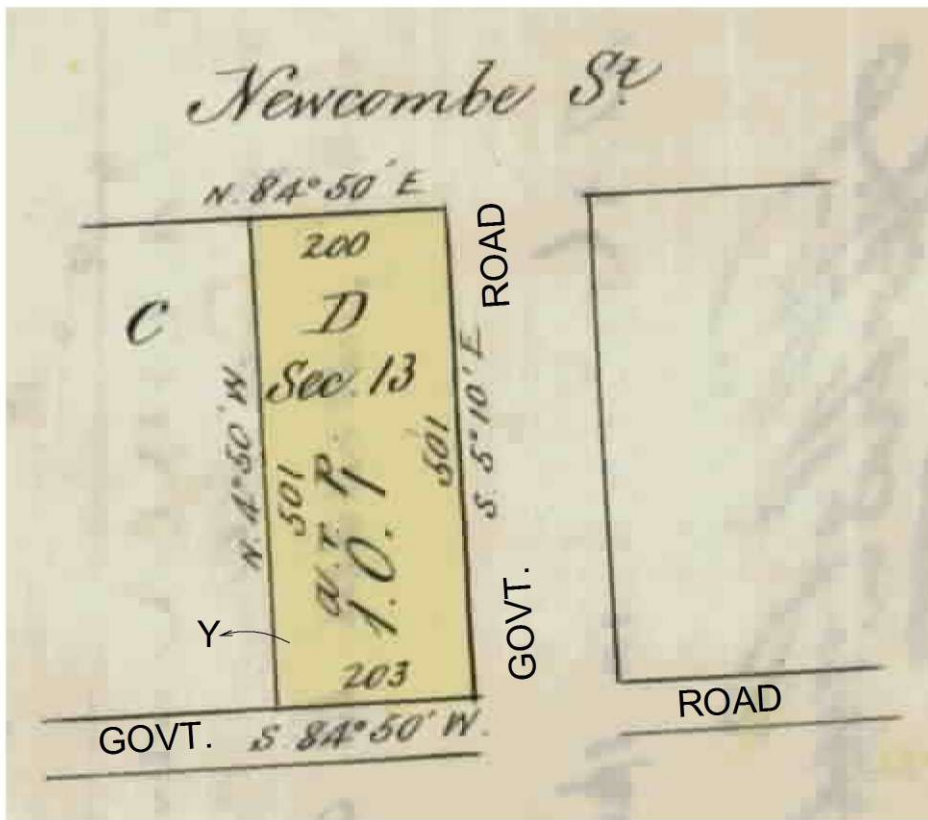

TITLE PLAN

TP 870646F

LAND DESCRIPTION INCLUDING RESERVATIONS, EXCEPTIONS, CONDITIONS AND POWERS SHOWN ON THE CROWN GRANT

All THAT PIECE OF LAND in the said Colony containing One acre and one perch more or less being allotment D of section thirteen Township of Drysdale in the parish of Ballaine County of Grant

delineated with the measurements and abutments thereof in the map drawn in the margin of these presents and therein colored yellow To hold unto the said GRANTEE

HIS/HERS heirs and assigns for ever

EXCEPTING however unto us our heirs and successors all gold and auriferous earth or stone and all mines containing gold within the boundaries of the said land AND ALSO reserving to us our heirs and successors free liberty and authority for us our heirs and successors and our and their agents and servants at any time or times hereafter to enter upon the said land and to search and mine therein for gold and to extract and remove therefrom any gold and any auriferous earth or stone and for the purposes aforesaid to sink shafts erect machinery carry on any works and do any other things which may be necessary or usual in mining PROVIDED ALWAYS that it shall be lawful for us our heirs and successors at any time on paying full compensation to the said GRANTEE

HIS/HERS heirs executors administrators or assigns for the full value other than auriferous of the said piece of land or so much thereof as may be resumed as hereinafter mentioned and of the improvements upon the said piece of land or the part so resumed such value in case of disagreement to be ascertained by arbitration to resume the said piece of land or any part thereof for mining purposes

AND THAT the terms conditions and events upon which such land may be resumed and the manner in which such arbitration may be conducted may be determined by regulations in such manner as the Governor in Council may from time to time direct or if at any time no such regulations shall be in force then by the regulations concerning the resumption of land for mining purposes in force at the date of this Grant unless Parliament shall otherwise determine

LENGTHS ARE IN LINKS

Metres = 0.3048 Feet
Metres = 0.201168 x Links