

Copyright State of Victoria. This publication is copyright. No part may be reproduced by any process except in accordance with the provisions of the Copyright Act and for the purposes of Section 32 of the Sale of Land Act 1962 or pursuant to a written agreement. The information is only valid at the time and in the form obtained from the LANDATA REGD TM System. The State of Victoria accepts no responsibility for any subsequent release, publication or reproduction of the information.

DOC: .....  
BOX: .....

REGISTER SEARCH STATEMENT (Title Search) Transfer of Land Act 1958

VOLUME 09548 FOLIO 193

Security no : 124061509886G  
Produced 29/07/2016 05:37 pm

LAND DESCRIPTION

Land in Plan of Consolidation 156863.  
PARENT TITLES :  
Volume 09484 Folio 830      Volume 09508 Folio 473  
Created by instrument CP156863 20/03/1984

REGISTERED PROPRIETOR

Estate Fee Simple  
TENANTS IN COMMON  
As to 1 of a total of 2 equal undivided shares  
Sole Proprietor  
    IMPALA LANE PTY LTD of 1 EDWARDS STREET ANGLESEA VIC 3230  
As to 1 of a total of 2 equal undivided shares  
Sole Proprietor  
    TW HART PTY LTD of 34 WATSON STREET MEREDITH VIC 3333  
    AJ515250F 27/02/2012

ENCUMBRANCES, CAVEATS AND NOTICES

MORTGAGE AJ515251D 27/02/2012  
NATIONAL AUSTRALIA BANK LTD

Any encumbrances created by Section 98 Transfer of Land Act 1958 or Section 24 Subdivision Act 1988 and any other encumbrances shown or entered on the plan or imaged folio set out under DIAGRAM LOCATION below.

DIAGRAM LOCATION

SEE CP156863 FOR FURTHER DETAILS AND BOUNDARIES

ACTIVITY IN THE LAST 125 DAYS

NIL

-----END OF REGISTER SEARCH STATEMENT-----

Additional information: (not part of the Register Search Statement)

Street Address: 1 FYANS STREET SOUTH GEELONG VIC 3220

DOCUMENT END.

CP156863

As to the land shown marked B TOGETHER WITH a right to use the land shown marked A on - - - Certificate of Title Vol.9508 Fol.473 for sewerage purposes- - - - -

**LIST OF MODIFICATIONS**

LAND	MODIFICATION	DEALING No.	A.R.T	EDN. No.
	APPURTENANT RIGHTS ENHANCED			2

LENGTHS ARE IN METRES

Metres = 0.3048 x Feet  
Metres = 0.201168 x Links

Sheet 2 of 2 Sheets

© State of Victoria. This publication is copyright. No part may be reproduced by any process except in accordance with the provisions of the Copyright Act and for the purposes of Section 32 of the Sale of Land Act 1962 or pursuant to a written agreement. The information is only valid at the time and in the form obtained from the LANDATA® System. The State of Victoria accepts no responsibility for any subsequent release, publication or reproduction of the information.

<b>PLAN OF CONSOLIDATION OF PART OF CROWN ALLOTS. 4 &amp; 5 SECTION 8<sup>c</sup></b>  <b>CITY OF GEELONG</b> <b>PARISH: CORIO</b> <b>COUNTY: GRANT</b>  SCALE OF METRES	<b>APPROPRIATIONS</b>
	<b>ENCUMBRANCES</b>

CP156863

TOWNSHIP  
Sheet 5

Y. 9484 F. 830  
Y. 9508 F. 473



LATROBE  
TERRACE  
SOUTH

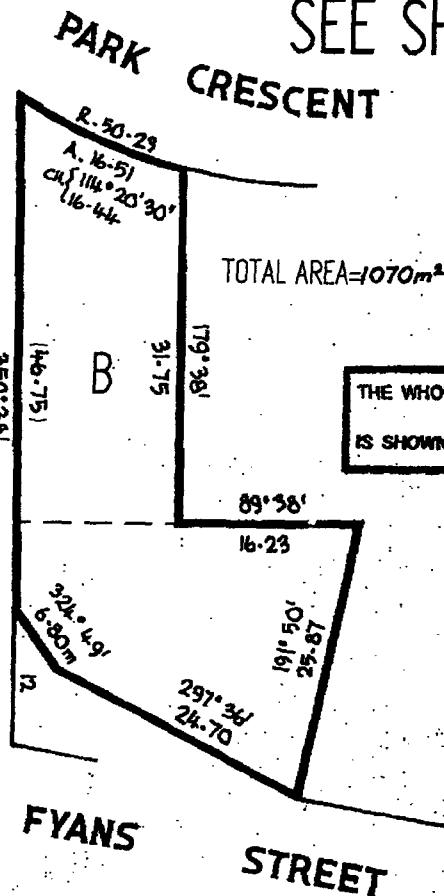

SEE SHEET 2 CP156863  
EDITION 2

*Accept  
Fees \$73.  
S/L K. 691258  
11.12.84*

**APPROVED**  
*[Signature]*  
Assistant Registrar of Titles  
DATE *20.3.84* TIME *8.55*

VOL. 9548 FOL. 193

CONSENT OF COUNCIL	SEAL	SURVEYOR'S CERTIFICATION
LOCAL GOVERNMENT ACT — SECTION 569 The Council of the... CITY OF... GEELONG... hereby consents to the Subdivision/Consolidation of Land as shown on this Plan; in witness whereof the Seal of the Municipality was hereto affixed this... 2 <sup>nd</sup> ... day of... <i>December</i> ... 19 <i>83</i> <i>[Signature]</i> Mayor Councillor  <i>[Signature]</i> Town Clerk Election Secretary		I certify that this plan has been made by G. W. THOMS and that it accords with Title  and is mathematically correct.  14 <sup>th</sup> day of NOV 1983 <i>G. W. Thoms</i> Licensed Surveyor
THOMS & PARTNERS PTY. LTD. • LICENSED SURVEYORS • 115 YARRA STREET • GEELONG • PHONE (052) 83147 • REF. No. 10604.		

Copyright State of Victoria. This publication is copyright.  
No part may be reproduced by any process except in accordance with  
the provisions of the Copyright Act and for the purposes of Section  
32 of the Sale of Land Act 1962 or pursuant to a written agreement.  
The information is only valid at the time and in the form obtained  
from the LANDATA REGD TM System. The State of Victoria accepts no  
responsibility for any subsequent release, publication or reproduction  
of the information.

REGISTER SEARCH STATEMENT (Title Search) Transfer of Land Act 1958

VOLUME 08063 FOLIO 334

Security no : 124061509902P  
Produced 29/07/2016 05:41 pm

LAND DESCRIPTION

Lot 1 on Title Plan 238016U.  
PARENT TITLE Volume 02684 Folio 632  
Created by instrument 2665884 13/08/1954

REGISTERED PROPRIETOR

Estate Fee Simple  
TENANTS IN COMMON  
As to 1 of a total of 2 equal undivided shares  
Sole Proprietor  
IMPALA LANE PTY LTD of 1 EDWARD STREET ANGLESEA VIC 3030  
As to 1 of a total of 2 equal undivided shares  
Sole Proprietor  
T W HART PTY LTD of 34 WATSON STREET MEREDITH VIC 3333  
AK581999K 10/09/2013

ENCUMBRANCES, CAVEATS AND NOTICES

Any encumbrances created by Section 98 Transfer of Land Act 1958 or Section  
24 Subdivision Act 1988 and any other encumbrances shown or entered on the  
plan set out under DIAGRAM LOCATION below.

DIAGRAM LOCATION

SEE TP238016U FOR FURTHER DETAILS AND BOUNDARIES

ACTIVITY IN THE LAST 125 DAYS

NIL

-----END OF REGISTER SEARCH STATEMENT-----

Additional information: (not part of the Register Search Statement)

Street Address: 4 PARK CRESCENT SOUTH GEELONG VIC 3220

DOCUMENT END

<b>TITLE PLAN</b>	<b>EDITION 1</b>	<b>TP 238016U</b>						
<p><b>Location of Land</b></p> <p>Parish: CORIO                  Township: GEELONG (CITY)                  Section: 8 C                  Crown Allotment: 4 (PT)                  Crown Portion:</p> <p>Last Plan Reference:                  Derived From: VOL 8063 FOL 334                  Depth Limitation: NIL</p>	<p style="text-align: center;"><b>Notations</b></p> <p>ANY REFERENCE TO MAP IN THE TEXT MEANS THE DIAGRAM SHOWN ON THIS TITLE PLAN</p>							
<p style="text-align: center;"><b>Description of Land / Easement Information</b></p> <p style="text-align: center;"><b>ENCUMBRANCES REFERRED TO</b></p> <p>As to the land coloured blue -</p> <p><u>THE SEWERAGE EASEMENT</u> reserved by Instrument of Transfer No.2665884 in the Register Book-</p>		<p>THIS PLAN HAS BEEN PREPARED FOR THE LAND REGISTRY, LAND VICTORIA, FOR TITLE DIAGRAM PURPOSES AS PART OF THE LAND TITLES AUTOMATION PROJECT</p> <p>COMPILED: 06/12/1999                  VERIFIED: AA</p>						
<p><b>COLOUR CODE</b> BL = BLUE</p>								
<table border="1" style="width: 100%; border-collapse: collapse;"> <tr> <th colspan="2" style="text-align: center;">TABLE OF PARCEL IDENTIFIERS</th> </tr> <tr> <td colspan="2" style="font-size: small;">WARNING: Where multiple parcels are referred to or shown on this Title Plan this does not imply separately disposable parcels under Section 8A of the Sale of Land Act 1962</td> </tr> <tr> <td colspan="2" style="font-size: small;">PARCEL 1 = CA 4 (PT)</td> </tr> </table>			TABLE OF PARCEL IDENTIFIERS		WARNING: Where multiple parcels are referred to or shown on this Title Plan this does not imply separately disposable parcels under Section 8A of the Sale of Land Act 1962		PARCEL 1 = CA 4 (PT)	
TABLE OF PARCEL IDENTIFIERS								
WARNING: Where multiple parcels are referred to or shown on this Title Plan this does not imply separately disposable parcels under Section 8A of the Sale of Land Act 1962								
PARCEL 1 = CA 4 (PT)								
LENGTHS ARE IN FEET & INCHES	Metres = 0.3048 x Feet Metres = 0.201168 x Links	Sheet 1 of 1 sheets						