

12,300 m²

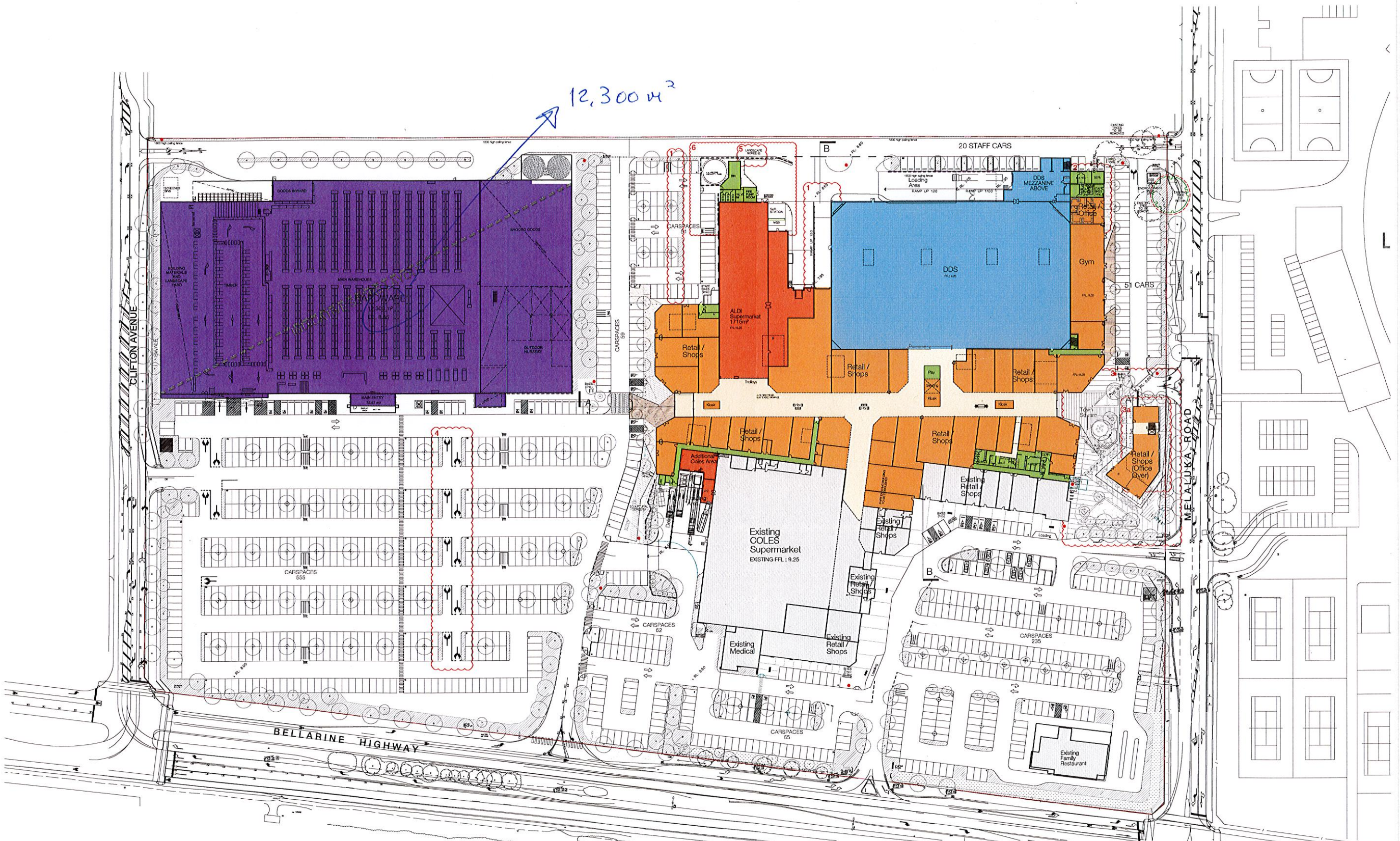

- 1 INCREASE IN LOADING AREA TO ALLOW FOR GROCER BACK OF HOUSE. 9 SPACES REMOVED IN CAR PARK TO ACCOMMODATE.
- 2 RELOCATION OF STAFF BIKE STORE AND SHOWERS ADJACENT TO OFFICE MANAGEMENT.
- 3 ADDITIONAL SEATING AREAS, PLAY AREA AND LANDSCAPING IN TOWN SQUARE. PASSIVE GRASSED AREAS INCLUDED AND EAT STREET DINING SEATING.
- 3a FIRST FLOOR OF TOWN SQUARE BUILDING CHANGE OF USE TO SHOP/OFFICE.
- 4 ADDITIONAL CAR PARK BREAKS TO ALLOW FOR BETTER FLOW. A REDUCTION OF 47 CAR SPACES TO ALLOW FOR AISLE BREAKS.
- 5 LANDSCAPE SCREENING TO LOADING IN LIEU OF SCULPTURAL SCREENING HEIGHT AND TRANSPARENCY STILL GENERALLY AS PREVIOUS.
- 6 ALDI EXTENSION TO THE REAR. A REDUCTION OF NUMBER OF TANKS TO 1x TANK, RELOCATION OF THE BIN AND STORAGE AREA, MODIFICATION TO THE LANDSCAPING AND SCREEN. A REDUCTION OF 2 CARSPACES TO THE STAFF PARKING, AND MODIFICATION TO THE ROOF PLAN AS A RESULT OF THE ALDI EXTENSION.

Expansion of Leopold SR Centre
 PP-1469-2014
 Amended plans 21/7/2016
 (approved)

GATEWAY SANCTUARY

PLANNING & ENVIRONMENT ACT 1987
 GREATER GEELONG PLANNING SCHEME
 Amended Plan Endorsed Under Condition 3
 of Permit 1445/2014 Date: 21/07/2016
 Signed: _____ Date: 21/07/2016
 For and on behalf of the Greater Geelong City Council
 as the Responsible Authority
 Sheet No. 1 of 1 sheets

CITY OF GREATER GEELONG
 STATUTORY PLANNING
 4 JULY 2016
 RECEIVED

PRIOR TO ANY WORKS COMMENCING
 Permits that may be required:
 - Vehicle Crossing Permit.
 - Works Within Road Reserve Permit.
 - Approval of drainage plans, if required.
 Contact: (03) 5272 4426 to arrange any inspections.
 Permits available at Council's Customer Service Centres

GENERAL NOTE: SIGNAGE SUBJECT TO SEPARATE APPLICATION